

General information

PWS17520241015

The PSTR tension load cell is made of stainless steel and is ideal for tensile loads and suspended loads, for measuring tensile forces, for dynamometric measurements and as a load limiting device for lifting systems combined with our instruments. The PSTR cell has a 10-meter shielded 4-conductor cable.



Suggested related products

A highly performing weighing system must be accurate, perfectly calibrated and well maintained. In order to improve the load cell performance and to optimize its functioning, you may need the following products:

Weight Transmitter [UWT 6008](#)

Weight Transmitter [DAT 1400](#)

Weight Indicator [MCT 1302](#)

All indicated data may be changed without notice.
All the measures indicated are expressed in millimeters (mm).

Technical specifications

PWS17520241015

Rated Load (RL):	5, 10, 20 t
Combined error:	< ± 0.03 % RO
Repeatability:	± 0.015 % RO
Creep (30 minutes):	0,03 % RO
Safe overload:	150 % RL
Ultimate overload:	> 300 % RL
Material:	Stainless steel
Degree of protection:	IP68
Deflection:	0.3 mm
Compensated Temperature:	-10°C ÷ +50°C
Temperature range:	-20°C ÷ +70°C
Temperature effect on zero balance:	± 0.005 % RO/°C
Temperature effect on output:	± 0.003 % RO/°C
Rated output RO:	2 mV/V ± 0.1 %
Zero balance:	± 1 %
Insulation resistance:	> 5000 MOhm
Input resistance:	350 Ohm ± 5
Output resistance:	350 ± 5 Ohm
Recommended input:	5 ÷ 15 Vdc/ac
Maximum supply voltage:	15 Volt
Cable Length:	10 m
Temperature effect on full scale:	0.003% /°C

All indicated data may be changed without notice.
 All the measures indicated are expressed in millimeters (mm).

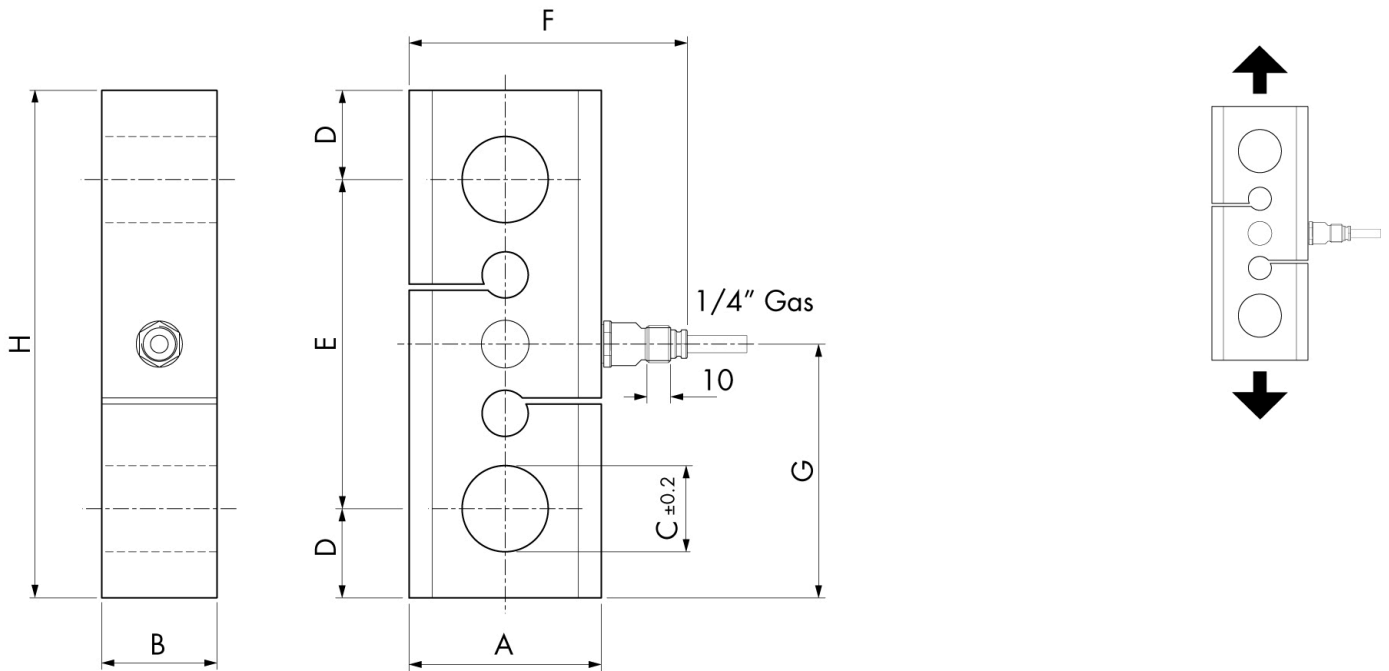

MODEL	A	B	C	D	E	F	G	H
5.000 - 10.000 KG	76	45	33	35	130	106	100	200
20.000 KG	82	54	52	47	166	112	130	260

All indicated data may be changed without notice.
 All the measures indicated are expressed in millimeters (mm).