

General information

PWS36720250222

Double shear load cell. Accuracy class $\pm 0.05\%$. Service temperature up to 150 °C. Measuring element from Alloy Steel with nickel plated treatment. Input cable connection through hermetic connector. Protected IP 67 (EN 60529). Applications: Ladle turret and ladle ferry scales, scrap bucket, roller table, tundish cars, hopper and silos in high temperature environments for the Metal Industry. Ideal to use with MC-315 or DAT S 400 or DAT 1400 without forgetting CGS 4 and the Tester 1008.



Suggested related products

A highly performing weighing system must be accurate, perfectly calibrated and well maintained. In order to improve the load cell performance and to optimize its functioning, you may need the following products:

Weight Transmitter [UWT 6008](#)

Weight Transmitter [DAT 1400](#)

Weight Indicator [MCT 1302](#)

Tester 1008 [TESTER 1008](#)

Junction Box [CGS4-C](#)

All indicated data may be changed without notice.
All the measures indicated are expressed in millimeters (mm).

Technical specifications

PWS36720250222

Rated Load (RL):	40, 50, 100, 150, 200 t
Combined error:	< ± 0.05 % RO
Repeatability:	< ± 0.04 % RO
Creep (30 minutes):	< ± 0.05 % RO
Safe overload:	150 % RL
Ultimate overload:	>= 180 % RL
Degree of protection:	IP 67
Accuracy class:	± 0.05 %
Deflection:	0.6 ÷ 1 mm
Compensated Temperature:	-10 ÷ +100 °C
Temperature range:	-30 ÷ +150 °C
Temperature effect on zero balance:	< ± 0.025 % RO / 5 °C
Temperature effect on output:	< ± 0.015 % RO / 5 °C
Rated output RO:	2 ± 0.25 % mV/V
Zero balance:	< ± 2 % RO
Insulation resistance:	> 5.000 M Ohm
Input resistance:	800 ± 30 Ohm
Output resistance:	700 ± 5 Ohm
Recommended input:	5 ÷ 15 Vdc/Vac

All indicated data may be changed without notice.
 All the measures indicated are expressed in millimeters (mm).

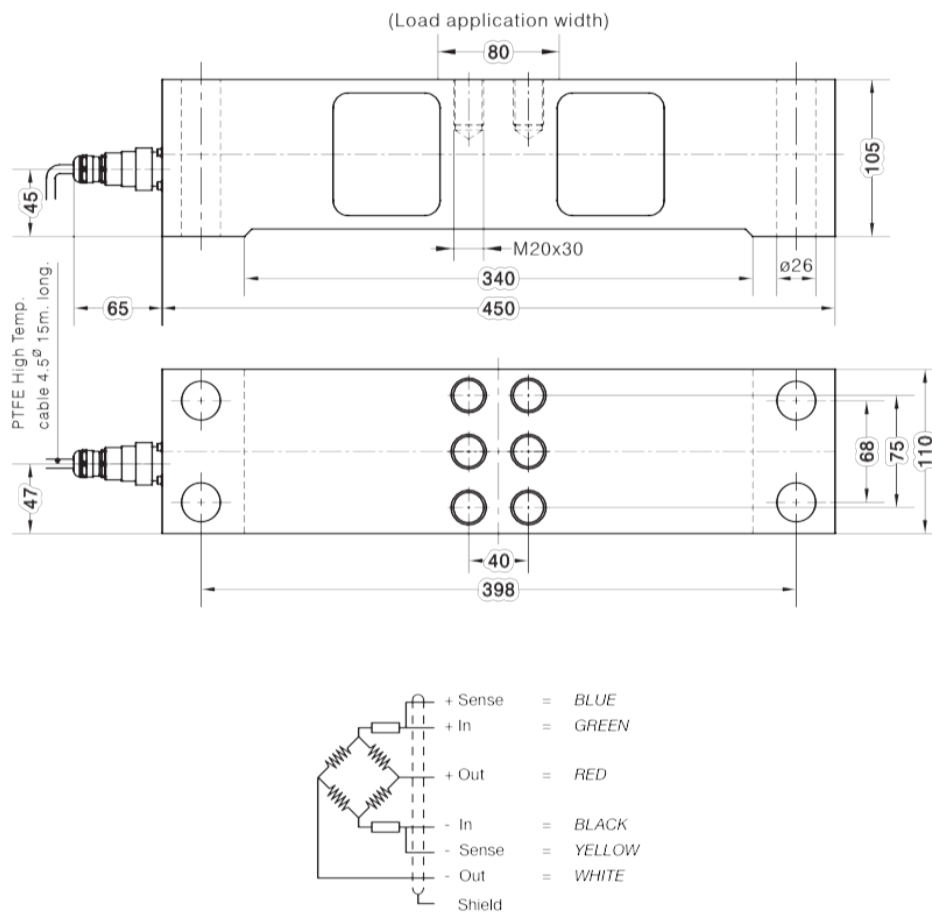
40 t Model

All indicated data may be changed without notice.
 All the measures indicated are expressed in millimeters (mm).

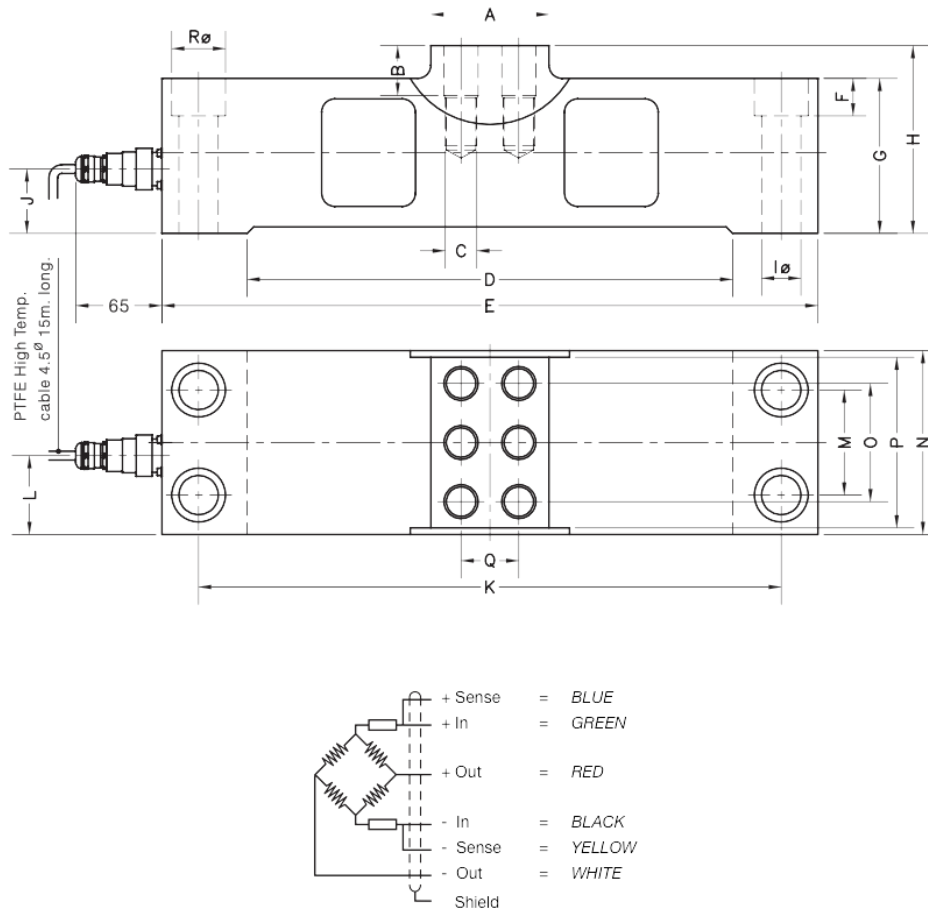
50 ÷ 200 t Model

CAPACITY	A	B	C	D	E	F	G	H	Iø	J	K	L	M	N	O	P	Q	Rø	WEIGHT
50 t	80	32	M20x30	340	450	25.5	105	130	26	45	398	52	68	120	75	110	40	38	36 kg
100 t	90	38	M24x36	370	500	28.5	118	143	30	49	444	58	80	140	90	130	44	41	54 kg
150 t	90	38	M24x36	410	560	32	133	158	33	66	500	67.5	94	160	102	150	44	46	81 kg
200 t	90	38	M24x40	450	620	32	150	175	33	70.5	560	64	114	180	110	170	44	46	116 kg

All indicated data may be changed without notice.
 All the measures indicated are expressed in millimeters (mm).